



LW4824



crochet

Designed by Michele Wilcox

What you will need:

RED HEART® Super Saver®:

1 skein each of 336 Warm Brown A, 316 Soft White B, and 319 Cherry Red C

Note: Only a small quantity of C is needed for this project.

Susan Bates® Crochet Hook:

4 mm [US G-6]

Yarn needle, polyester fiberfill

GAUGE: 4 sc = 1" (2.5 cm); 4 rows = 1" (2.5 cm). **CHECK YOUR GAUGE.** Use any size hook to obtain the gauge.

Buy Yarn



RED HEART® Super Saver®, Art. E300 available in solid color

7 oz (198 g), 364 yd (333 m); prints, multis and heathers 5 oz (141 g), 236 yd (215 m), flecks 5 oz (141 g), 260 yds (238 m) skeins



Gingerbread Tree Ornaments

Crochet a sweet gingerbread family to hang on the tree with their gingerbread house. Heart trims proclaim their love! You may also use them as gift tie-ons or to make a sweet banner.

**Man and Lady measure 5½" (14 cm) tall.
House measures 5" (12.5 cm) tall.
Baby measures 4½" (11.5 cm) tall.**

Special Stitches

sc2tog = [Insert hook in next stitch, yarn over and pull up a loop] twice, yarn over and draw through all 3 loops on hook.

sc3tog = [Insert hook in next stitch, yarn over and pull up a loop] 3 times, yarn over and draw through all 4 loops on hook.

Special Technique

Join with sc = Place a slip knot on hook, insert hook in indicated stitch, yarn over and draw up a loop, yarn over and draw through both loops on hook.

Notes

1. Each ornament is made from 2 pieces worked back and forth in rows that are sewn together and stuffed.
2. To change color, work last stitch of old color to last yarn over. Yarn over with new color and draw through all loops on hook to complete stitch. Proceed with new color. Cut old color.
3. To minimize weaving in, you may prefer to pull ends to wrong side of front after pieces are sewn on and tuck ends in as front and back are sewn together.

ORNAMENTS

Large Heart (make 3)

With C, ch 2.

Round 1 (right side): Work 6 sc in 2nd ch from hook—6 sc. Do not join.

Round 2: (Sc, ch 2, sc) in first sc, slip st in next sc, 2 hdc in next sc, ch 1, slip st in next sc, ch 1, 2 hdc in next sc, slip st in next sc; join with slip st in first sc. Fasten off, leaving long tail for sewing.



MAN

Body (make 2)

Beginning at top of head, with A, ch 4.

Row 1 (right side): Work 2 sc in 2nd ch from hook, sc in next ch, 2 sc in last sc, turn—5 sc.

Row 2: Ch 1, sc in first sc, *2 sc in next sc, sc in next sc; repeat from * across, turn—7 sc.

Rows 3–6: Ch 1, sc in each sc across, turn.

Row 7: Ch 1, sc2tog, sc3tog, sc2tog, turn—3 sc.

Continued...



2015
WOMEN'S CHOICE AWARD®
AMERICA'S MOST RECOMMENDED
YARN BRAND



Please Note: Print this pattern using Landscape Orientation.

Find more ideas & inspiration: redheart.com

©2015 Coats & Clark

RedHeart.com

Page 1 of 3

Row 8: Ch 6, sc in 2nd ch from hook and in next 4 ch, sc in next sc, 2 sc in next sc, sc in last sc, turn—9 sc.

Row 9: Ch 6, sc in 2nd ch from hook and in next 4 ch, sc in each sc across, turn—14 sc.

Row 10: Ch 1, sc2tog, sc in next 10 sc, sc2tog, turn—12 sc.

Row 11: Ch 1, sc in first 10 sc; leave remaining sts unworked, turn—10 sc.

Row 12: Ch 1, sc in first 8 sc; leave remaining sts unworked, turn—8 sc.

Rows 13 and 14: Ch 1, sc in each sc across, turn.

First Leg

Row 1 (right side): Ch 1, sc in first 2 sc, sc2tog; leave remaining sts unworked, turn—3 sc.

Rows 2 and 3: Ch 1, sc in each sc across, turn.

Row 4: Ch 1, sc in first 2 sc, 2 sc in last sc, turn—4 sc.

Row 5: Ch 1, 2 sc in first sc, sc in last 3 sc, turn—5 sc.

Row 6: Ch 1, sc in each sc across. Fasten off.

2nd Leg

Row 1 (right side): With right side facing, join **A** with sc in first unworked sc of Row 14, sc in next 2 sc; leave remaining sts unworked, turn—3 sc.

Rows 2 and 3: Ch 1, sc in each sc across, turn.

Row 4: Ch 1, 2 sc in first sc, sc in last 2 sc, turn—4 sc.

Row 5: Ch 1, sc in first 3 sc, 2 sc in last sc, turn—5 sc.

Round 6: Ch 1, sc in each sc across; working across ends of rows, in sts, and in opposite side of foundation ch, sc evenly spaced around working 2 sc as needed in rows at curved edges; join with slip st in first sc. Fasten off, leaving long tail on one piece for sewing.

FINISHING MAN

1. Select one piece as front. Leave remaining piece unworked.

Edging Round (right side): With right side facing and working in front loops only, join **A** with sc in any sc, sc in each sc around; join with slip st in first sc.

2. With **B**, embroider French knot eyes and 3 French knots across each arm and leg. Using photograph as a guide, embroider small straight stitches under eyes for smiling mouth.

3. Sew large heart on front.

4. Working through unworked back loops of Edging Round and both loops of back, sew front and back together, tucking in ends and stuffing lightly as you go.

5. Hanging Loop Join **B** with slip st to center of top of head, ch 15, slip st in same st as joining st. Fasten off.

Weave in ends.



LADY

Body (make 2)

Work same as man.

Bib Apron

Bib

With **B**, ch 5.

Row 1 (right side): Ch 1, sc in 2nd ch from hook and each ch across, turn—4 sc.

Rows 2–4: Ch 1, sc in each sc across, turn.

Row 5: Ch 1, sc in each sc across. Do not turn.

Apron

Row 1 (right side): Ch 1, work 5 sc evenly spaced across ends of rows, turn—5 sc.

Rows 2 and 3: Ch 1, 2 sc in each sc across, turn—20 sc.

Rows 4–6: Ch 1, sc in each sc across, turn. Fasten off, leaving a long tail for sewing.

FINISHING LADY

Work Steps 1 and 2 of Finishing Man instructions.

Sew large heart on apron. Sew apron to front of lady.

Work Steps 4 and 5 of Finishing Man instructions. Weave in ends.



BABY

Body (make 2)

Beginning at top of head, with **A**, ch 4.

Row 1 (right side): Work 2 sc in 2nd ch from hook and each ch across, turn—6 sc.

Rows 2–5: Ch 1, sc in each sc across, turn.

Row 6: Ch 1, [sc2tog] 3 times, turn—3 sc.

Row 7: Ch 5, sc in 2nd ch from hook and in next 3 ch, sc in next sc, 2 sc in next sc, sc in next sc, turn—8 sc.

Row 8: Ch 5, sc in 2nd ch from hook and in next 3 ch, sc in each sc across, turn—12 sc.

Row 9: Ch 1, sc2tog, sc in last 10 sc, turn—11 sc.

Continued...



Please Note: Print this pattern using Landscape Orientation.

Find more ideas & inspiration: redheart.com

©2015 Coats & Clark

Row 10: Ch 1, sc2tog, sc in next 7 sc; leave remaining sts unworked, turn—8 sc.
Row 11: Ch 1, sc in first 6 sc; leave remaining sts unworked, turn—6 sc.

First Leg

Row 1 (wrong side): Ch 1, sc in first 3 sc; leave remaining sts unworked, turn—3 sc.
Row 2: Ch 1, sc in each sc across, turn.
Row 3: Ch 1, 2 sc in first sc, sc in next 2 sc, turn—4 sc.
Row 3: Ch 1, sc in each sc across. Fasten off.

2nd Leg

Row 1 (wrong side): With wrong side facing, join **A** with sc in first unworked sc of Row 11, sc in next 2 sc, turn—3 sc.
Row 2: Ch 1, sc in each sc across, turn.
Row 3: Ch 1, sc in first 2 sc, 2 sc in last sc, turn—4 sc.
Row 4: Ch 1, sc in each sc across.
Round 5: Work same as Round 6 of man.

Bib

With **B**, ch 2.
Row 1 (right side): Work 4 sc in 2nd ch from hook, turn.
Row 2: Ch 1, sc in first sc, 2 sc in next 2 sc, sc in last sc, turn—6 sc.
Row 3: Ch 1, sc in first sc, *2 sc in next sc, sc in next 2 sc; repeat from * across, turn—8 sc.
Row 4: Ch 1, sc in each sc across, turn.
Row 5: Ch 1, sc in next sc, sc2tog, sc in next 2 sc, sc2tog, sc in last sc, turn—6 sc.
Row 6: Ch 1, sc in next sc, [sc2tog] twice, sc in last sc. Fasten off, leaving a long tail for sewing.

FINISHING BABY

Work Steps 1 and 2 of Finishing Man instructions.
 Using photo as a guide and with 2 strands of **C** held together, embroider heart on bib with 2 lazy daisy stitches. Begin and end each stitch in same place in center of bib, angling stitches away from each other. Sew bib to front.
 Work Steps 4 and 5 of Finishing Man instructions. Weave in ends.



HOUSE

Front
 With **A**, ch 14.
Row 1 (right side): Ch 1, sc in 2nd ch from hook and in each ch across, turn—13 sc.
Rows 2–6: Ch 1, sc in each sc across, turn.
Row 7: Ch 1, sc in each sc across; change to **B**, turn.
Row 8: Ch 1, sc in each sc across, turn.

Row 9: Ch 1, working in back loops only, sc2tog, sc in each sc across to last 2 sc, sc2tog; change to **A**, turn—11 sc.
Row 10: Ch 1, sc in each sc across, turn.
Row 11: Ch 1, sc2tog, sc in each sc across to last 2 sc, sc2tog, turn—9 sc.
Rows 12–17: Repeat last 2 rows 3 times—3 sc.
Round 18: Ch 1, sc3tog; working down first side, sc in end of each row; working in opposite side of foundation ch, 3 sc in first ch, sc in each ch across to last ch, 3 sc in last ch, working up other side, sc in end of end of each, 3 sc in first sc; join with slip st in next st. Fasten off.

Back

Work same as front, omitting all color changes.

Window

With **B**, ch 8; join with slip st in first ch to form a ring.
Round 1 (right side): Ch 1, 12 sc in ring. Do not join.
Round 2: Slip st in front loop of first sc, *ch 2, skip next sc, slip st front loop of next sc; repeat from * around, ch 2, skip last sc; join with slip st in first slip st. Fasten off.

FINISHING HOUSE

On front, work Edging Round of Finishing Man instructions.
 Trim With right side of front facing and held upside down (top of piece closest to you), join **B** with slip st in first unworked loop of Row 9, *ch 4, skip next unworked loop, slip st in next unworked loop; repeat from * across. Fasten off, leaving a long tail. Tack loops down.
 Using photograph as a guide, sew window in place and embroider 2 crossing straight stitches for panes.

With **C**, embroider a French knot in center of each ch-4 space of trim. With **B**, embroider French knots around sides and lower edge of front.
 Work Steps 3–5 of Finishing Man instructions.
 Weave in ends.

ABBREVIATIONS

A, B, C = Color A, Color B, Color C, etc.; **ch** = chain(s); **hdc** = half double crochet; **sc** = single crochet; **st(s)** = stitch(es); **()** = work directions in parentheses into same st; **[]** = work directions in brackets the number of times specified; * = repeat whatever follows the * as indicated.

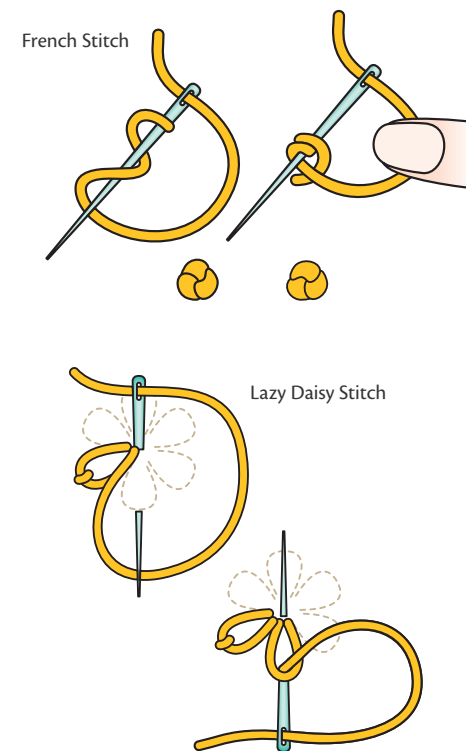

Please Note: Print this pattern using Landscape Orientation.